

# V951

## ELECTROMAGNETIC FLOW METER



### Product Description

V951 Electromagnetic Flow Meter is basically a transducer that measures fluid flow by the voltage induced across the liquid by its flow through a magnetic field. A magnetic field is applied to the metering tube, which results in a potential difference proportional to the flow velocity perpendicular to the fluidity lines. The physical principle at work is electromagnetic induction.



Technical Data	
Size range	DN3 - DN3000
Pressure range	PN10 - 16 - 25 - 40
Temperature	Rubber -25 °C to +60 °C / Teflon -20 °C to 150°C
Connection Type	Flanged EN / ANSI / JIS
Body	Carbon Steel / Stainless Steel 304/316(optional)
Measurement Range	0.2 - 15m/s max.
Coil Material	Carbon Steel / Stainless Steel 304/316(optional)
Minimum Conductivity	5µs/cm
Inner Lining Material	PTFE / Neoprene / Rubber / F46 / PFA / Polyurethane
Electrode Material	SS316L / Hastelloy B / Hastelloy C / Titanium / Tantal / Platinum
Accuracy	0.5% / ± 0.3% and ± 0.2%(optional)
Input Voltage	AC85-250V / DC20-36V
Supply Voltage	4-20mA, Pulse, RS485 Modbus (optional) / HART, Profibus (optional)
Alarm Status	Empty Pipeline, Warning, Lower and Upper Limit
Display	3 line LCD Display
Cable Input	M20 x 1.5 / 1/2 "NPT (optional)
Ex-proof	Exmd II T4
Insulation Class	IP65 / IP67 IP68(optional)

### Application Range

- Water & Wastewater
- Mining
- Mineral Processing
- PowerStation
- Pulp and paper industry
- Chemical Industries

### Related Products

- V106 Butterfly Valve Series 14 Double Eccentric
- V151 Gate Valve Resilient Seated F4 NRS
- V251 Dismantling Joint Heavy Type



WASTE WATER



IRRIGATION



POTABLE WATER

# V951

## ELECTROMAGNETIC FLOW METER



### Product Features

- Measures the fluid free of density, humidity, temperature, pressure and conductivity
- Full bore, relatively shorter pipe is required for proper installation
- The precise sensor is equipped with advanced processing technology which provides excellent immunity to negative pressures
- LCD with light enables easy data reading in dark environment
- Through the infrared touch nubs parameters can be set easily without the need for opening the converter cover
- Converter is equipped with alarm function in case of self-diagnosis, empty load test, high and low limit of flow, two phase flow data
- Available to wide range of applications
- High-pressure sensors equipped with PFA lining resists to high and negative pressures
- Measuring principle is according to Faraday' law of electromagnetic induction

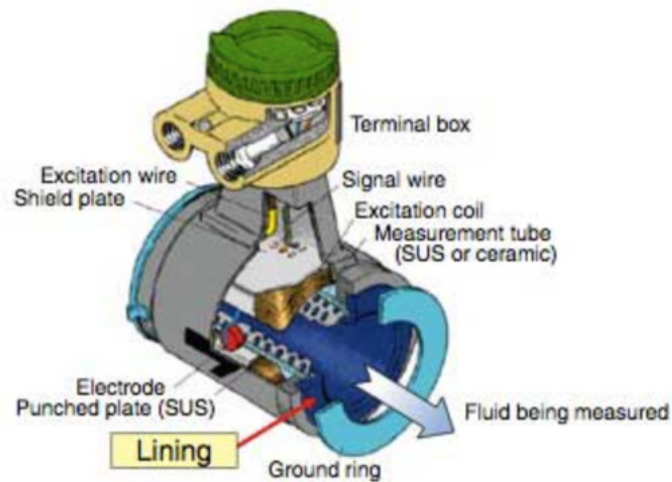

# V951

## ELECTROMAGNETIC FLOW METER



### Dimensions Table

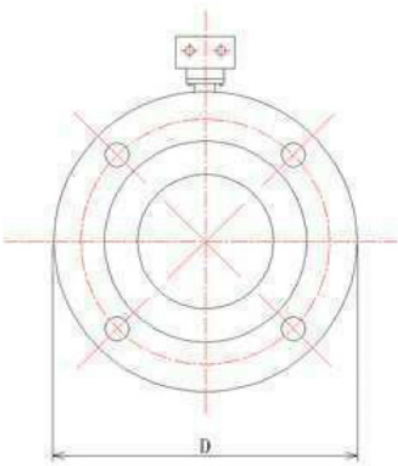
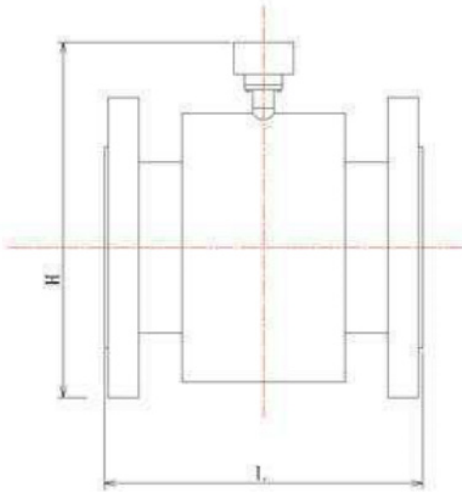

Nominal Diameter(DN)	Nominal pressure (bar)	Dimensions				Unit Weight (kg.)
		L PTFE Liner	L Neoprene Liner	D	H	
3	40	200(PFA)		90	220	4
6		200(PFA)		90	220	5
10		200	-	90	220	6
15		200	-	95	220	8
20		200	-	105	220	10
25		200	-	115	223	12
32		200	-	140	240	13
40		200	200	150	250	14
50		200	200	165	263	15
65		200	200	185	283	18
80		200	200	200	290	20
100		250	250	235	318	25
125		250	250	270	350	28
150		300	300	300	380	30
200		16	350	350	340	430
250	450		450	405	495	70
300	500		500	460	547	95
350	550		550	520	602	120
400	600		600	580	665	140
450	600		600	640	720	160
500	600		600	715	783	200
600	600	600	840	897	280	
700	10	700	700	895	982	350
800		800	800	1015	1092	400
900		900	900	1115	1192	480
1000	6	1000	1000	1230	1299	550
1200		1200	1200	1405	1488	660
1400		1400	1400	1630	1700	750
1600		1600	1600	1830	1924	850
1800		1800	1800	2045	2134	980
2000		2000	2000	2265	2344	1200
2200		2200	2200	2475	2549	1600
2400		2400	2400	2685	2754	2000
2600		2600	2600	2905	3169	2400
2800		2800	2800	2905	3169	2700
3000	3000	3000	3315	3369	2900	