

V755

FULLY WELDED BALL VALVE



Product Description

TVN V755 Fully Welded Ball Valves are designed and manufactured for the pipelines where 'tight sealing' is required. Quarter turn design enables easy and faster operation. The body made by welding 3 pieces, enables high pressure resistance.

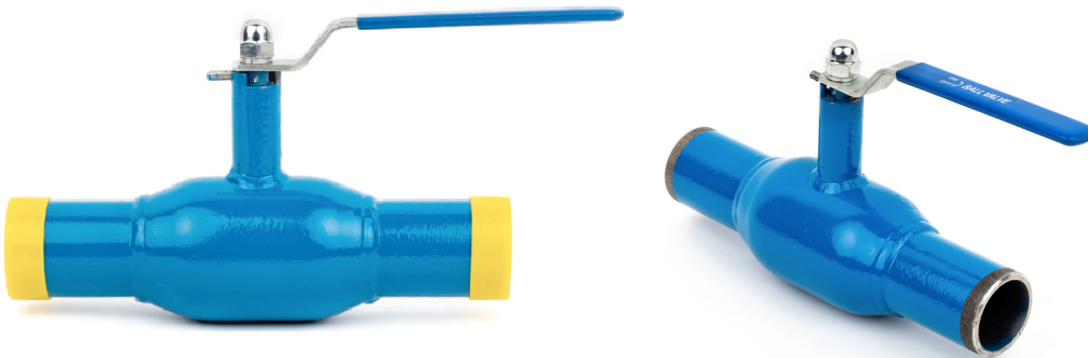

Technical Data

Size range	DN15 - DN300
Pressure range	PN 16-25
Temperature	-10°C to +220 °C
Design	EN 12627
Face to face	EN 12627
Connection	Butt Welded Ends
Coating	Industrial Epoxy
Testing	EN 12266-1
Marking	EN 19
Operation	Handlever

Application Range

- Natural Gas
- LPG
- Steam boilers and steam systems
- Pressurized air systems
- Determined chemical fluids

Related Products

- V851 Y-Strainer
- V651 Rubber Expansion Joint
- V208 Wafer Swing Check Valve
- V209 Dual Plate Check Valve
- V200 Lift Check Valve



HVAC



POTABLE WATER

V755

FULLY WELDED BALL VALVE



Product Features

- Smooth and flawless body binding is achieved through fully automated welding machines.
- Non-leakage is possible from the body due to non-mechanical type of assembly.
- Through the single body design, the stress and elongation and compression on the pipeline due to high temperature differences affecting the valve performance is eliminated.
- Can be manufactured with variable stem sizes and extension spindles.
- It is suitable for underground installation.
- Can be installed directly to the pump without any need for additional intermediary parts.
- Suitable to install pneumatic or electrical actuator and gearbox.
- Easy to install due to the pipe shaped body.
- It is appropriate to be used in fully open or fully closed position.
- Can be operated with lower torque rates.
- Hydrostatic test pressure for seat: $PN \times 1.1$ (e.g.: $PN 16 = 17.6$ bar); for shell: $PN \times 1.5$ (e.g.: $PN16 = 24$ bar) according to EN 12266-1.



*V756 Fully Welded Ball Valve with Flanges

V755

FULLY WELDED BALL VALVE



Material List

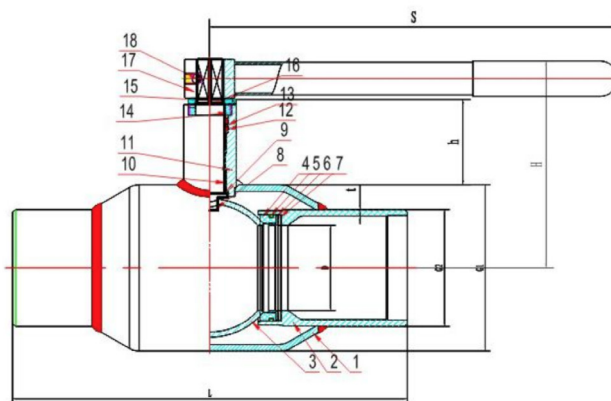

No	Part	Material
1	Body Pipe	ST37 Steel - 1.0037
2	Connection Pipe	ST37 Steel - 1.0037
3	Ball	AISI 304 Stainless Steel
4	Seat	PTFE+C
5	Seat O-Ring	FPM
6	Support Ring	60Si2Mn Stainless Steel
7	Disc Spring	60Si2Mn Stainless Steel
8	Stem	2Cr13(304)
9	Thrust Gasket	Graphite
10	Bearing	Mild Steel
11	Branch Pipe	ST37 Steel - 1.0037
12	Stem O-Ring	FPM
13	Gasket	Graphite
14	Packing Gland	AISI 304 Stainless Steel
15	Stop Block	AISI 304 Stainless Steel
16	Circlip	65Mn - Stainless Steel
17	Lever	ST37 Steel - 1.0037
18	Hexagonal Screw	ST37 Steel - 1.0037

V755

FULLY WELDED BALL VALVE



Dimensions Table

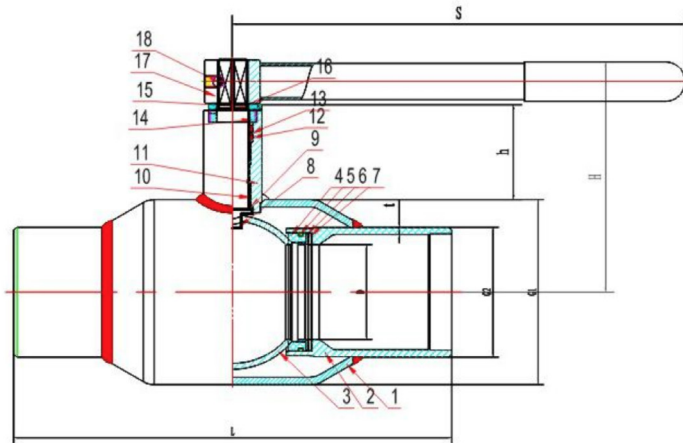

DN	PN	L	D	G1	G2	H	h	t	s
15	40	230	10	33.7	21.3	85	42	2	115
20	40	230	15	42.4	26.7	90	40	2.3	115
25	40	230	20	48.3	33.7	95	40	2.6	150
32	40	260	25	60.3	42.4	100	38	2.6	150
40	40	260	32	76.1	48.3	130	50	2.6	170
50	40	300	39.5	88.9	60.3	135	50	2.9	170
65	25	300	50	108	76.1	150	53	2.9	290
80	25	300	65	127	88.9	175	65	3.2	310
100	25	325	81.5	159	114	210	75	3.6	380
125	25	325	102	193.7	140	235	77	4	400