

V754

THREADED BALL VALVE



Product Description

TVN V754 Threaded Ball Valves are robust and reliable ball valves for fitting in between PN16 networks. Ductile iron body material and stainless steel ball and stems are improving the durability of the valve. The valves are offering a large wide range of applications in thanks to PTFE sealing.



Technical Data

Size range	DN65 - DN100
Pressure range	PN 16
Temperature	-10°C to +200 °C
Design	EN 331 – EN1983
Face to face	DIN3202 / M3
Connection	Threaded EN ISO 228-1
Coating	Industrial Epoxy
Testing	EN 12266-1 / EN331
Marking	EN 19
Operation	Handlever

Application Range

- LPG
- Natural Gas
- Steam
- Super-heated water
- Industrial applications

Related Products

- V751 Flanged Ball Valve
- V851 Y-Strainer
- V209 Dual Plate Check Valve
- V200 Lift Check Valve



HVAC



POTABLE WATER

Product Features

- GGG40 ball valves can be used in almost all process industries like water distribution networks, food and pharmaceutical plants, water treatment, power plants as well as in machinery automation industries.
- The stainless steel ball & stem and sealing mechanism, ensures the valve for high temperature usage.
- It is advised to be used either at fully open or fully closed position.
- The ball valves open/close position can be easily observed from the handle lever position easily.
- PTFE sealing provides long service life with zero leakage rates.
- The valves are designed for bidirectional usage.
- Through its full bore design, pressure loss is almost at zero point.
- Flange connections according to EN1092-2 / ISO 7005-2.
- Up to request, the body material can be GGG40 ductile iron.
- By adding an ISO top flange, the valve operation can be maintained by gearbox, pneumatical or electrical actuator.
- To provide a long service life, filtering of the pipeline by TVN V851 Y-Strainer is advised.
- Hydrostatic test pressure for seat: PN x 1.1 , for shell: PN x 1.5 according to EN 12266-1.

Material List & Dimensions Table

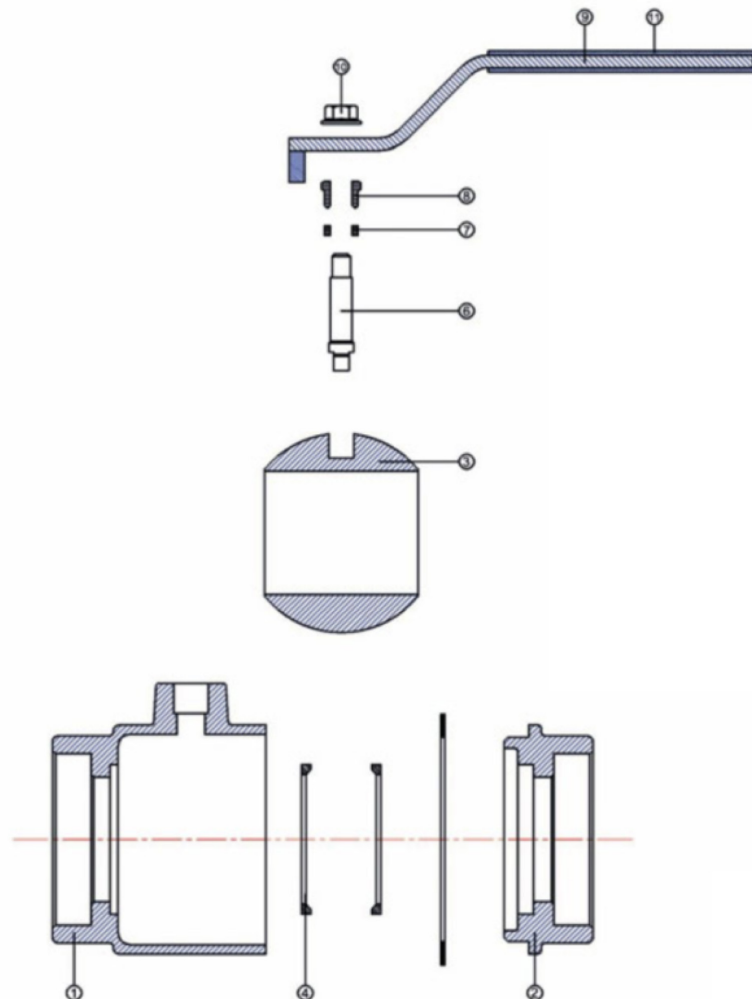

V754

THREADED BALL VALVE



Material List & Dimensions Table

No	Part	Material
1	Body	GGG40 Ductile Iron
2	Bonnet	GGG40 Ductile Iron
3	Ball	GGG40 Ductile Iron / AISI 304-316 Stainless Steel
4	Seat	PTFE
5	Body Sealing	PTFE
6	Stem	Galvanized Steel / AISI 420 Stainless Steel
7	Stem Sealing	PTFE
8	Stem Nut	Galvanized Steel / AISI 420 Stainless Steel
9	Handlever	ST37 Steel
10	Nut	Galvanized Steel / AISI 420 Stainless Steel
11	Handlever Cover	PVC
12	Bolt	Galvanized Steel / AISI 420 Stainless Steel
13	Nut	Galvanized Steel / AISI 420 Stainless Steel

DN mm	Connections			
	R"	L	H	G
65	2½"	140	138	265
80	3"	160	145	265
100	4"	175	155	265