

# V753

## GAS BALL VALVE SHORT TYPE



### Product Description

TVN V751 PN10-16 2 Piece Ball Valves are designed and manufactured for the pipelines where 'tight sealing' is required. Quarter turn design enables easy and faster operation. Ball valves with 2 pieces, simple construction allow easy maintenance over a long working life, therefore preferred for industrial applications as well as for utility services.

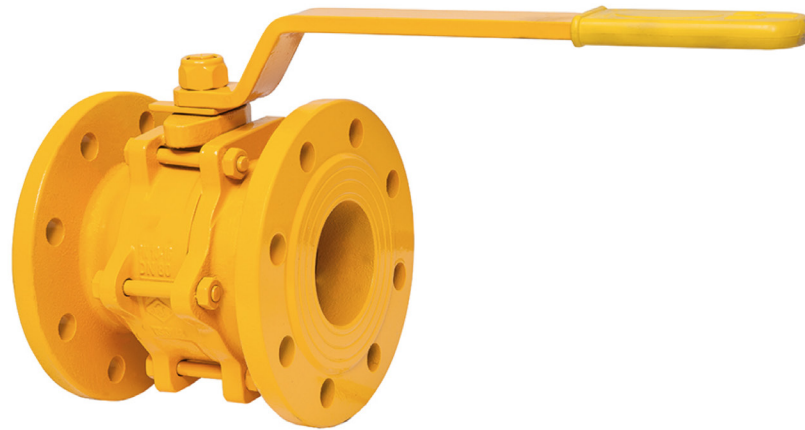

#### Technical Data

Size range	DN15 - DN250
Pressure range	PN 10-16
Temperature	-10°C to +200 °C
Design	EN 331
Face to face	EN 558 Series 1 / DIN3202 F1
Flange drilling	EN 1092-2 ISO 7005-2 Flanged
Coating	Industrial Epoxy
Testing	EN 12266-1
Marking	EN 19
Operation	Handlever
	Electrical Actuators

#### Application Range

- Natural Gas
- LPG
- Steam boilers and steam systems
- Pressurized air systems
- Determined chemical fluids

#### Related Products

- V851 Y-Strainer
- V651 Rubber Expansion Joint
- V208 Wafer Swing Check Valve
- V209 Dual Plate Check Valve
- V200 Lift Check Valve



HVAC



GAS

# V753

## GAS BALL VALVE SHORT TYPE



### Product Features

---

- GG25 body ball valves can be used in almost all process industries gas distribution network and many industries.
- The stainless steel ball & stem and sealing mechanism, ensures the valve for high temperature usage.
- It is advised to be used either at fully open or fully closed position.
- The ball valves open/close position can be easily observed from the handle lever position easily.
- PTFE sealing provides long service life with zero leakage rates.
- The valves are designed for bidirectional usage.
- Through its full bore design, pressure loss is almost at zero point.
- Flange connections according to EN1092-2 / ISO 7005-2.
- Up to request, the body material can be GGG40 ductile iron.
- By adding an ISO top flange, the valve operation can be maintained by gearbox, pneumatically or electrical actuator.
- To provide a long service life, filtering of the pipeline by TVN V851 Y-Strainer is advised.
- Hydrostatic test pressure for seat: PN x 1.1 , for shell: PN x 1.5 according to EN 12266-1.

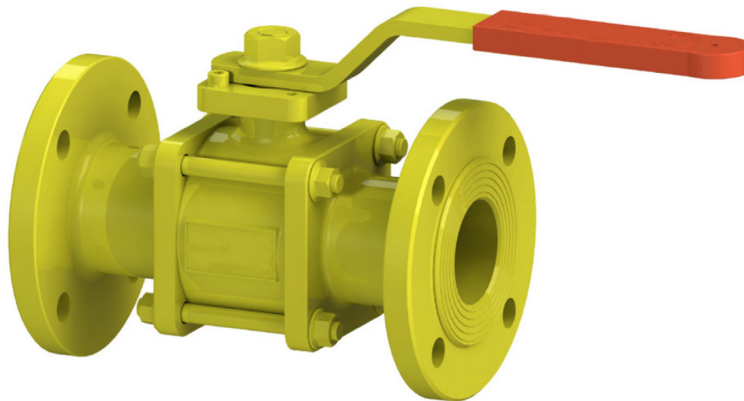

\*Long type gas ball valves are available upon request.

# V753 GAS BALL VALVE SHORT TYPE



## Material List

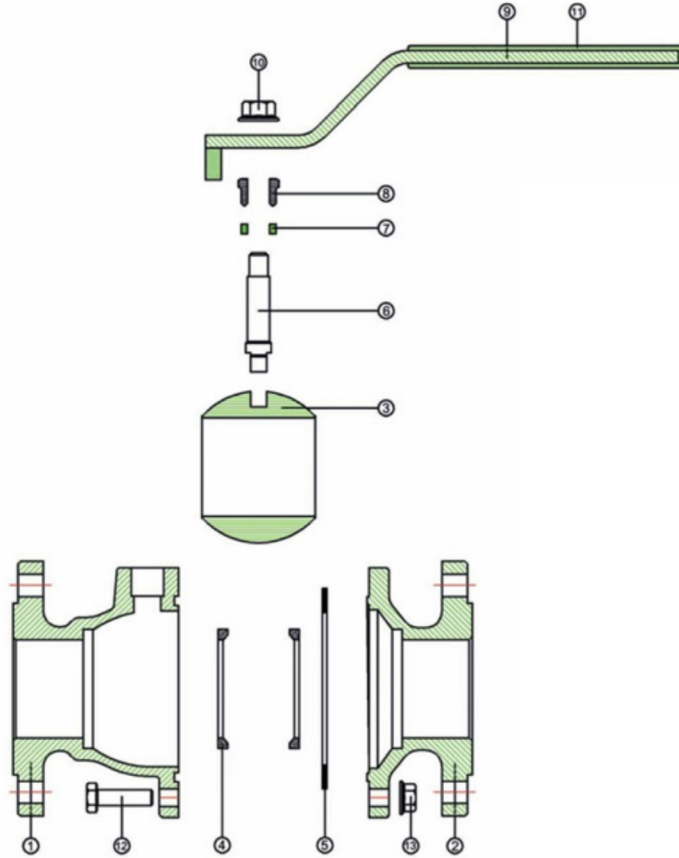

No	Part	Material
1	Long Body	EN-GJL-250 Cast Iron (GG25) / EN-GJS-400 Ductile Iron (GGG40)
2	Short Body	EN-GJL-250 Cast Iron (GG25) / EN-GJS-400 Ductile Iron (GGG40)
3	Ball	AISI 430 / AISI 304 Stainless Steel
4	Ball Sealing	PTFE
5	Body Sealing	PTFE
6	Stem	AISI 420 Stainless Steel
7	Stem Sealing	PTFE
8	Stem Nut	AISI 1040 Steel
9	Handlever	ST-37 Steel
10	Nut	AISI 1030 Steel
11	Lever Cover	PVC
12	Bolt	AISI 1030 Steel
13	Nut	AISI 1030 Steel

# V753

## GAS BALL VALVE

### SHORT TYPE



#### Dimensions Table

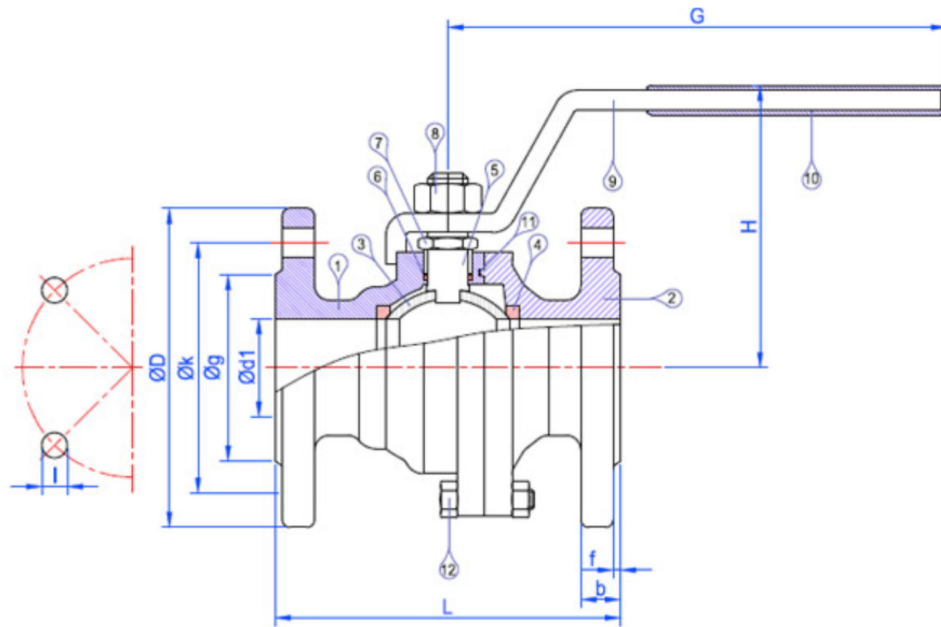

DN		Dimensions									
mm	d	L	g	k	D	l	f	b	H	G	Hole
25	1"	125	65	85	115	14	3	16	90	150	4
32	1 1/4"	130	76	100	140	19	3	18	108	200	4
40	1 1/2"	140	84	119	150	19	3	18	138	200	4
50	2"	150	99	125	165	19	3	20	115	200	4
65	2 1/2"	170	118	145	185	19	3	20	125	200	4
80	3"	180	132	160	200	19	3	22	150	270	8
100	4"	190	156	180	220	19	3	24	165	270	8
125	5"	200	184	210	250	19	3	26	195	328	8
150	6"	210	211	240	286	23	3	26	215	370	8
200	8"	400	266	295	340	23	3	30	250	400	12
250-R	10"	450	319	355	405	28	3	30	250	400	12