

# V532

## BOOSTER PUMP CONTROL VALVES - HORIZONTAL STEM



### Product Description

V532 Booster Pump Control Valves are designed to automatically activate and deactivate pumps without damaging the system. It is connected to the system in series. It turns on with the pump together. When the system is shut down, the pump is turned off after the valve. It prevents the system from pressure fluctuations during opening and closing process. It acts like a hydraulic check valve at the same time. The Booster control Valve can be controlled by control time relay, switch, PLC control panel and similar control equipment.



Technical Data	
Size range	DN40 - DN300
Pressure range	0,7 - 16 bar ( 10 - 240 psi )
Temperature	-10°C to +80 °C
Flange drilling	Flanged EN 1092-2 / ISO 7005-2 Threaded ISO (BSP) - ANSI (NPT)
Coating	Polyester Epoxy
Testing	EN 12266-1
Marking	EN 19

### Application Range

- Water applications
- Household implementation
- Supply of water fire extinguishing
- Various applications of industrial systems.
- Food and chemical enterprises

### Assembly

- Valve can be installed horizontally or vertically.
- Valve must be on the same alignment with pipelines during installation.
- Install the valve on direction with arrow shown on the valve.
- Isolation valves (gate valve, butterfly valve, silt trap etc.) could be installed before or after the installation.
- Connect Solenoid valve and limit switch to Control Panel according to electrical schematic.

### Working Principle

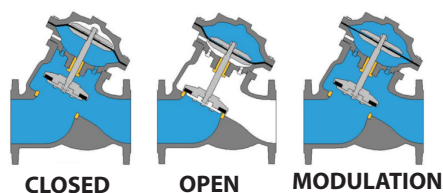

IRRIGATION



POTABLE WATER



FIRE FIGHTING

# V532

## BOOSTER PUMP CONTROL VALVES - HORIZONTAL STEM



### Product Features

- Runs on main water pressure without needing additional energy
- Classification by importance of pressure areas
- Pressure reduction without being affected by pressure and flow rates on the system
- Controlled waterline flow on curved systems
- Easy maintenance

### Application System

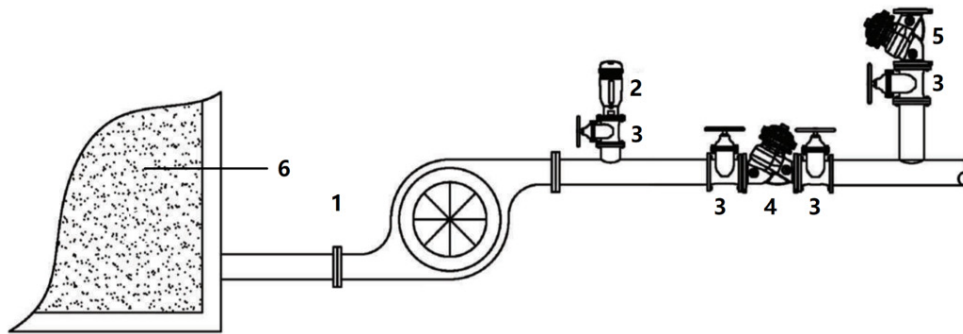

- 1- Pump
- 2- Air Release Valve
- 3- Isolation Valve
- 4- Horizontal Stem Booster Pump Control Valves
- 5- Surge Anticipating Valves

# V532 BOOSTER PUMP CONTROL VALVES - HORIZONTAL STEM



## Material List

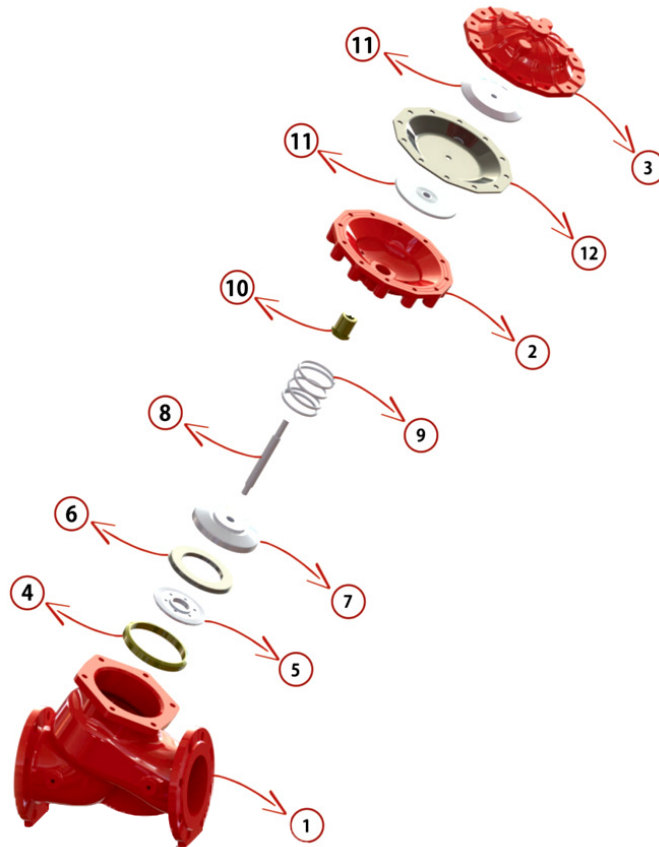

No	Part	Material
1	Body	GGG50 Ductile Iron
2	Centre Piece Body	GGG50 Ductile Iron
3	Bonnet	GGG50 Ductile Iron
4	Sealing Ring	Brass / Bronze
5	Disc Cover	AISI 420 / 304 / 316 Stainless Steel
6	Disc Gasket	Buna-N
7	Disc	AISI 420 / 304 / 316 Stainless Steel
8	Shaft	AISI 420 / 304 / 316 Stainless Steel
9	Spring	AISI 420 / 304 / 316 Stainless Steel
10	Centre Piece Body Shaft Nut	Brass / Bronze
11	Diaphragm Disc	AISI 420 / 304 / 316 Stainless Steel
12	Diaphragm	Neopren

# V532

## BOOSTER PUMP CONTROL VALVES - HORIZONTAL STEM



### Dimensions Table

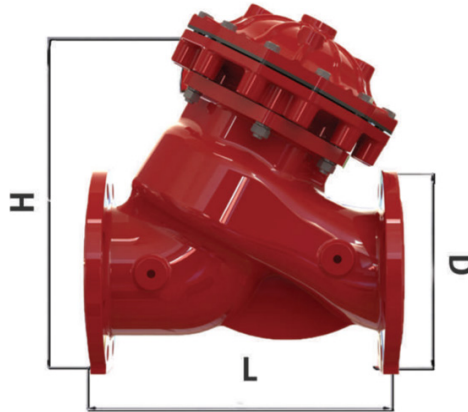

DN		L		D		H		Weight	
inch	mm	inch	mm	inch	mm	inch	mm	lbs	kg
2"	50	8.4	215	6.2	165	10.6	270	13	5.9
2½"	65	8.6	220	7.2	185	11.3	288	14	6.4
3"	80	10.6	270	7.8	200	13.3	340	26	11.8
4"	100	12.9	330	8.6	220	15.3	390	38	17.2
5"	125	13.1	335	9.8	250	16.5	420	39	17.7
6"	150	16.9	430	11.2	285	20.4	520	80	36.3
8"	200	21.2	540	13.2	340	26.2	668	142	64.4
10"	250	24.4	620	16	407	30.5	775	230	104.3
12"	300	25.9	660	18.3	466	33.4	850	370	167.8