

V208

WAFER TYPE SWING CHECK VALVE



Product Description

TVN V208 Wafer Type Swing Check Valve construction is formed with the disc fixed on the body, opening in the direction of flow and closing with the backflow and works as a non-return valve. In a wafer connection swing check valve, the check valve is installed between the pipe flanges and tightened to its place with the bolts for the pipe flanges.



Technical Data	
Size range	DN25 - DN400
Pressure range	PN 16
Temperature	-10°C to +200 °C
Face to face	EN 558 Series 97
Connection	Wafer Type EN 1092-1 / ISO 7005-1
Testing	EN 12266-1
Marking	EN 19

Application Range

- Steam
- Hot & cold water
- Power & heat engineering
- Pressurized Air
- Industrial technologies
- Fluids without acidity or alkalinity properties

Body & Disc Variations

- ST-37 Body / 1040 Disc
- ST-37 Body / SS304 Disc
- ST-37 Body / SS316 Disc
- SS304 Body / SS304 Disc
- SS316 Body / SS316 Disc

Gasket Variations

- Metal Seated
- EPDM
- Silicone
- VITON
- PTFE

V102 Wafer Type Butterfly Valves

- V104 Lug Type Butterfly Valves
- V851 Y-Strainer



Product Features

- V208 type is with Steel body and SS304 Disc. (SS304 Body & Disc is optional)
- EPDM sealing/sleeve/gasket is by default. Different sealing materials are available
- With its compact design saves space, light weight, easy to install and budget friendly
- Even the disc is located within the flow section, with the precisely calculated disc design pressure loss is kept at minimum level
- Fully coated body avoids corrosion
- Do not need any maintenance, easy to make spare part replacements
- No need for additional gaskets for installation on the pipeline
- With its long neck design, suitable for insulation application
- In built hook facilitates installation between two flanges
- Spring feature on disc can be added on request.
- Can be used vertically or horizontally
- Hydrostatic test pressure for seat: PN x 1.1 , for shell: PN x 1.5 according to EN 12266-1.

Material List & Dimensions Table

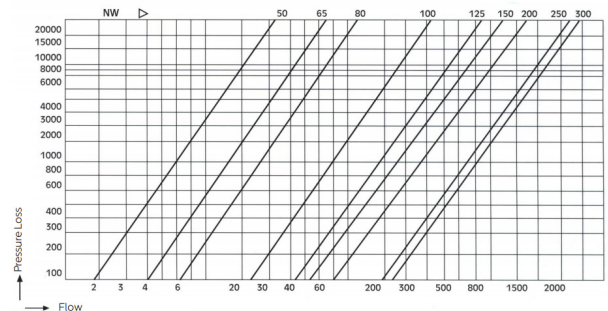
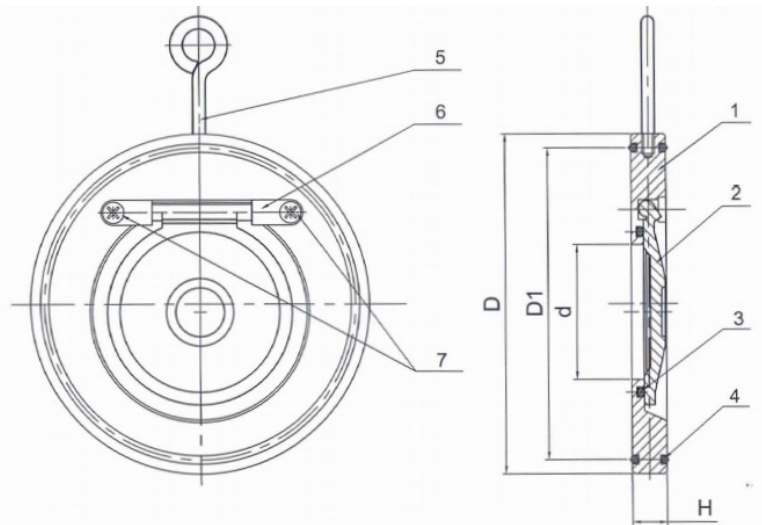

No	Part	Material
1	Body	Carbon Steel / AISI 304-316 Stainless Steel
2	Disc	Carbon Steel / AISI 304-316 Stainless Steel
3	O-Ring	EPDM/Viton
4	O-Ring	EPDM/Viton
5	Hook	SS304 Stainless Steel
6	Blocker	SS316 Stainless Steel
7	Disc Bearing	SS316 Stainless Steel

DN	d	D	D1	H	KG
32	20	76	59	12	0.32
40	25	85	68	12	0.52
50	32	105	84	14	0.79
65	40	124	96	14	1.1
80	54	136	118	14	1.3
100	70	164	148	18	2.26
125	92	194	166	18	3.15
150	114	220	197	20	4.54
200	154	275	249	22	7.65
250	200	330	310	26	12.6
300	230	380	358	30	20