

V153

RESILIENT SEATED GATE VALVE



Product Description

TVN V153 Resilient Seated Gate Valves are designed to last long years of operation in many conditions. With its bolted bonnet structure, EPDM covered wedge and hygienic coating, ready to meet the demand for potable water & sewage applications.



Technical Data	
Size range	DN40 - DN600
Pressure range	PN10 - 16 - 25
Temperature	EPDM : -10°C to +130 °C NBR :- 10°C to + 100 °C
Design	EN 1171
Face to face	EN 558 Series 15 / DIN 3202 F5
Flange drilling	EN 1092-2 / ISO 7005-2
Coating	Thermoplastic Powder Epoxy
Testing	EN 12266-1
Marking	EN 19
Operation	Handwheel
	Operation Cap
	Manual gearbox with handwheel
	Electrical Actuators

Application Range

- Potable water applications
- Waste water
- Water treatment and distribution systems
- Mining industry
- Shipbuilding and drilling facilities
- Chemical and petrochemical plants
- Food and chemical enterprises
- Oil and gas processes
- Heating, ventilation and air conditioning systems

Related Products

- V251 Dismantling Joint
- V991 Surface Box
- V993 Extension Spindle
- V851 Y-Strainer
- V301 Air Release Valve
- V651 Rubber Expansion Joint
- V201 Swing Check Valve



POTABLE WATER



WASTE WATER



INDUSTRY

Product Features

- GGG40/50 Ductile Iron Body & Disc allows high impact and stretching resistance
- With Full Bore design, ensures minimized pressure loss and increased energy efficiency
- Maintenance free valve design
- Fully EPDM vulcanised wedge maintains full stop of flow and can absorb smaller particulates in the flow. (NBR coated wedge is optional)
- Stainless steel stem with threads for high strength
- Maintenance-free and corrosion-resistant multi stem O-rings ensures higher durability
- Brass wedge nut provides fixation of the stem and low torques.
- With isolated bonnet nuts, no risk of corrosion
- Bidirectional use. Possible to install on horizontal and vertical pipelines with varied flow directions
- Fixed wedge structures prevents vibration
- With precise machined stem, ensures low torque requirements during operation
- Full coating on the body and disc internally & externally with an average of 250 microns. Higher coating thicknesses are available when required.
- WRAS approved coating available upon request which meets hygienic requirements for potable water applications
- For big size valves, balanced positioned lifting holes on the body ease transportation and installation
- Suitable for vacuum conditions
- Suitable for shut-off and isolation purposes. Not suitable for regulation purposes
- Electrical actuator connection is done with an intermediate top flange arrangement
- Suitable to use with above-underground applications. Can be operated with handwheel, gearbox, actuator and extension spindle



*TVN V153 F5 Resilient Seated Gate Valves are suitable for usage with electrical actuators.

V153

RESILIENT SEATED GATE VALVE



Material List

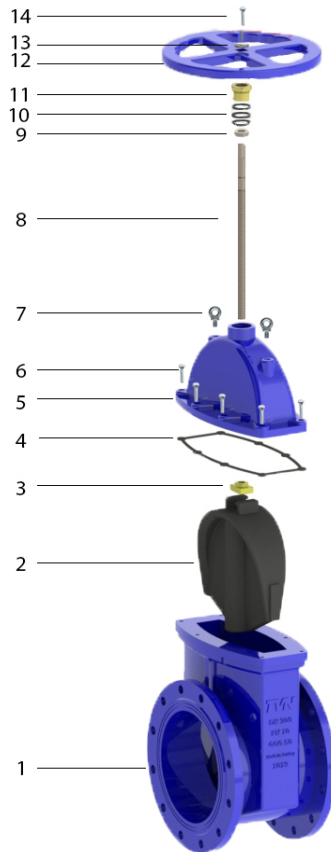

NO	Part	Material
1	Body	GGG50 Ductile Iron
2	Wedge	EPDM/NBR Coated GGG50 Ductile Iron
3	Wedge Nut	MS 58 Brass
4	Bonnet Sealing	EPDM
5	Bonnet	GGG50 Ductile Iron
6	Bonnet Bolt	8.8 Galvanized Steel / A2/A4 Stainless Steel
7	Lifting Lug	8.8 Galvanized Steel / A2/A4 Stainless Steel
8	Stem	AISI 420/304/316/316L Stainless Steel
9	Nut	AISI 420/304/316/316L Stainless Steel
10	O-Ring	EPDM/NBR
11	Stem Nut	MS 58 Brass
12	Handwheel	GGG50 Ductile Iron
13	Washer	8.8 Galvanized Steel / A2/A4
14	Bolt	8.8 Galvanized Steel / A2/A4

V153

RESILIENT SEATED GATE VALVE



Dimensions Table

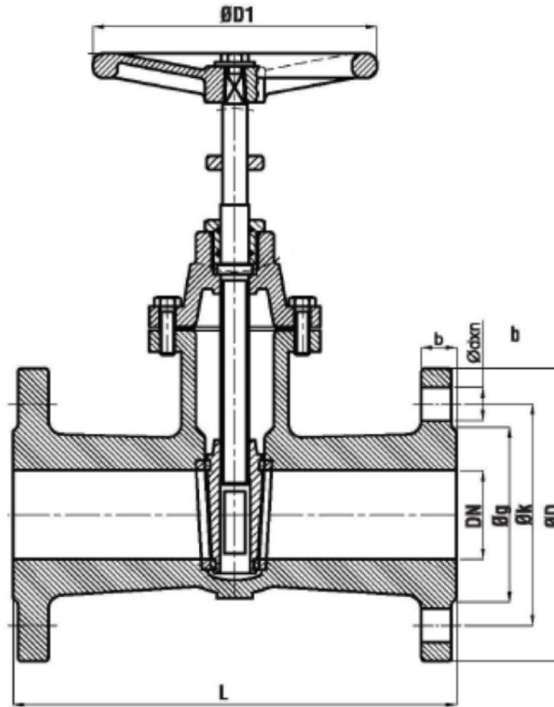

DN	L	D	nx d	k
40	240	150	4x18	110
50	250	165	4x18	125
65	270	185	4x18	145
80	280	200	8x18	160
100	300	220	8x18	180
125	325	250	8x18	210
150	350	285	8x22	240
200	400	340	8/12x22	295
250	450	395	12x26	355
300	500	445	12x26	410
350	550	505	16x26	470
400	600	565	16x30	525
500	700	670	20x33	650